



Whitehall Manufacturing®
 Manufacturer of Healthcare and Rehabilitation Products since 1946

BestCare®
 Patients, Not Prisoners®

**Healthcare and Ligature
 Resistant Products**

**CAPE COD SYSTEMS
 CORPORATION**
TEL. 1-888-227-8555

**Whitehall
 Ligature Resistant
 Flush Valve Cover with
 Sensor Operated
 Flush Valve**

Model WH2802SLPT-SO

Division of
 Acorn Engineering Company®



A MEMBER OF



WH2802SLPT-SO-EG10

**Ligature Resistant Flush Valve
 Cover with Sensor Operated Flush
 Valve**

Recommended for Toilets with top supply (exposed) Flush Valve connections where Vandalism or Ligature Resistance is a concern.

Sensor Operated Flush Valve is a exposed type with cast Bronze Body. Flush Valve includes a ligature resistant Sensor Panel with an Electrical Override Button, Union Angle Stop and Vacuum Breaker. All exposed parts are polished chrome plate.

Flush Valve Cover is 16 gage, type 304 stainless steel with all exposed surfaces powder coated white. It is furnished with six removable Wall Brackets secured with Vandal Resistant Screws.

GUIDE SPECIFICATION

Provide and install Ligature Resistant Flush Valve Cover with Sensor Operated Flush Valve. Flush Valve Cover shall be fabricated from 16 gage type 304 stainless steel. All exposed stainless steel surfaces are powder coated white. Flush Valve shall be Sensor Operated with an Electric Override Pushbutton with Cover and secured with stainless steel Vandal Resistant Fasteners, Wall Anchors and Anchoring Hardware by others.

Please visit www.whitehallmfg.com for most current specifications.



Member of
 U.S. Green
 Building
 Council



Recyclable
 Product



Water
 Conserving
 Product

Whitehall Mfg. • P.O. Box 3527 • City of Industry, CA 91744 • (800) 782-7706 • (626) 968-6681 • Fax (626) 855-4862

WH2802SLPT-SO

New: 03/20/19



MODEL AND OPTIONS SELECTION:

BASE MODEL NUMBER

TOILET

- WH2802SLPT-SO-EG10-1.28 Ligature Resistant Flush Valve Cover With 1.28 GPF Sensor Operated Flush Valve
- WH2802SLPT-SO-EG10-1.6 Ligature Resistant Flush Valve Cover With 1.6 GPF Sensor Operated Flush Valve

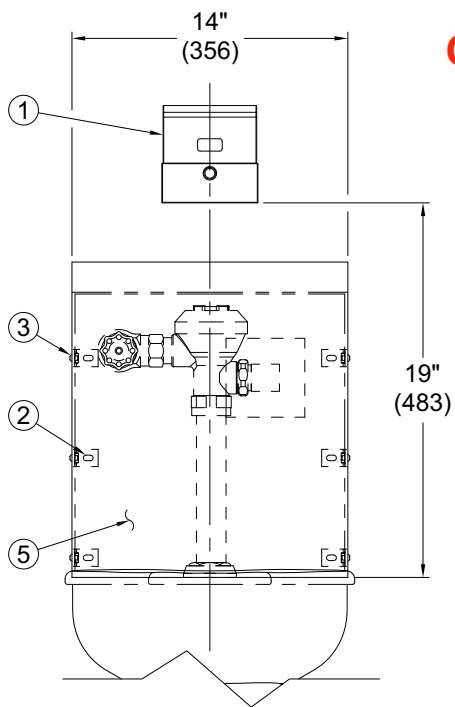

**CAPE COD SYSTEMS
 CORPORATION
 TEL. 1-888-227-8555**

TOILET SHOWN
 FOR REFERENCE

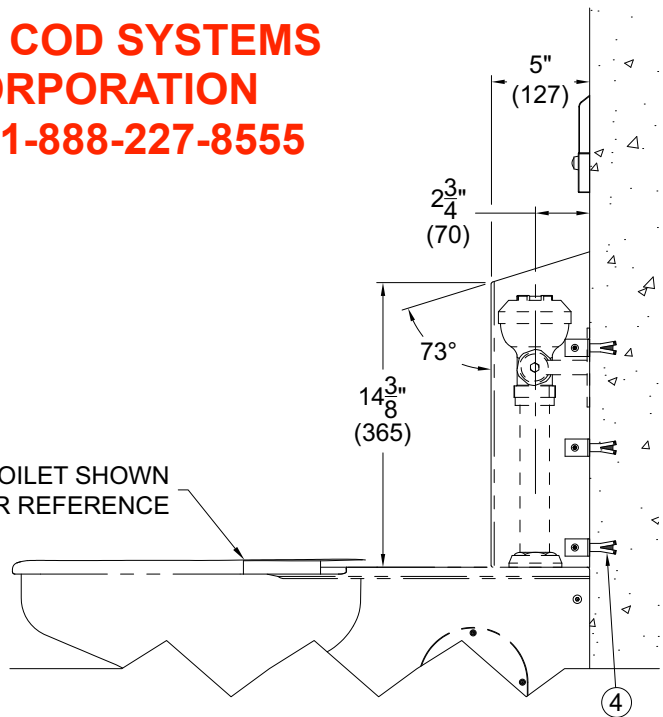

MODEL# WH2802SLPT-SO-EG10

NOTES:

- 1. Ligature Resistant Sensor Panel With Override Pushbutton
- 2. Mounting Clips
- 3. Vandal Resistant Fasteners
- 4. Wall Anchors And Anchoring By Others
- 5. Ligature Resistant Flush Valve Cover

DISCLAIMER:

This product is designed to decrease the probability that it may be utilized as an apparatus for ligature. It is not a replacement for professionals who are trained in the proper evaluation, management and supervision of persons at risk of suicide.

WARNING: Cancer and Reproductive Harm - www.P65Warnings.ca.gov

SELECTION SUMMARY & APPROVAL FOR MANUFACTURING

Model Number & Options _____ Quantity _____
 Company _____ Date _____
 Contact _____ Title _____
 Approval for Manufacturing/Signature _____

All dimensions are nominal and subject to manufacturer's change without notice. Whitehall assumes no responsibility for use of void or superseded data © Whitehall Manufacturing, Member of Morris Group International. Please visit www.whitehallmfg.com for most current specifications.