

# How to measure drop-in sinks for Faucets

In order to properly measure for custom-made suicide prevent faucet you will need a straight piece of cardboard approximately 4" inches by 30" inches.

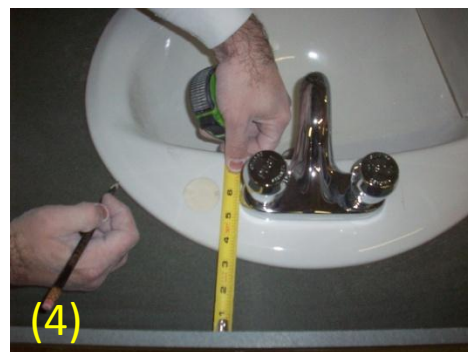

Depending on which faucet you are going to order (i.e. 4" or 8"). Fold the cardboard as seen in the photo. The inside dimensions width must be 7 1/4" inches for 4" faucet and 10 3/4" inches for 8 inch faucet.

Next, temporarily remove the template and measure the distance from the backsplash to the center of the faucet handle.

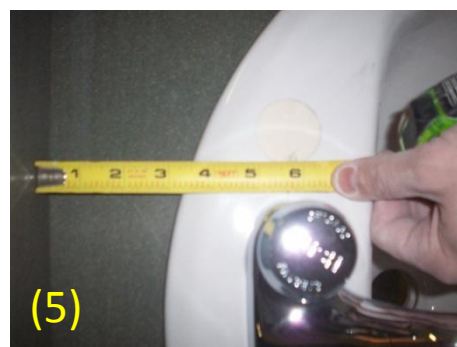
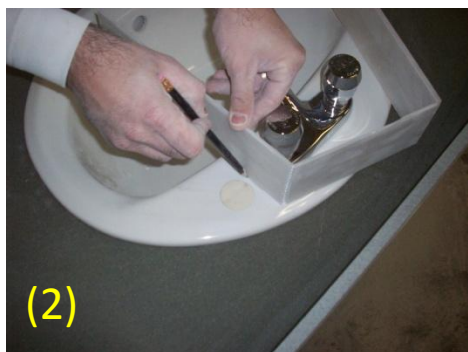

It is important to ensure the width of the template is either 7 1/4" or 10 3/4" and the corners are at 90 degrees.

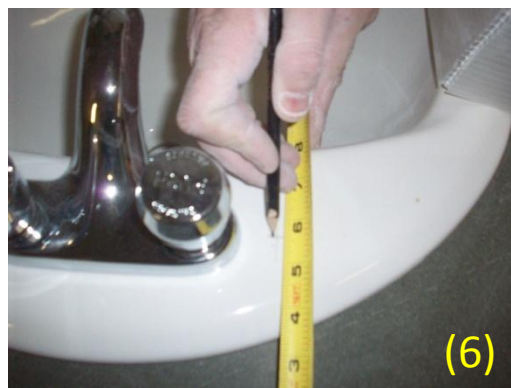
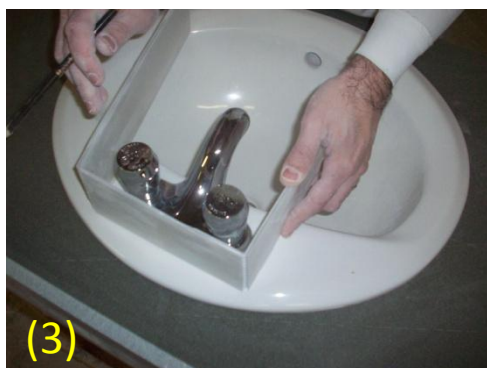

Mark the fixture to indicate the center of the faucet handle

Note: A template will need to be completed for each different sink model. Please call us if you have any questions.



While the template is against the backsplash, carefully cut out a notch for the bow lip.

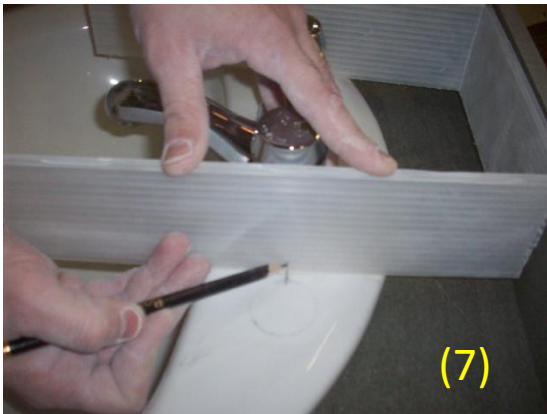

While holding the template, place it around the faucet and up against the backsplash. Using the mark on the fixture, mark on the template the center of the faucet handle.

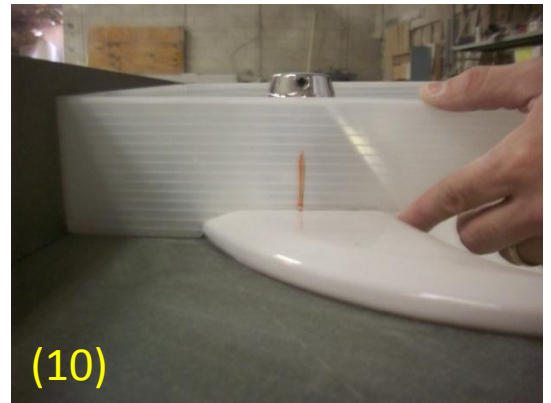

Ensure the notch is properly aligned with the backsplash, fixture and the center of the faucet handle.

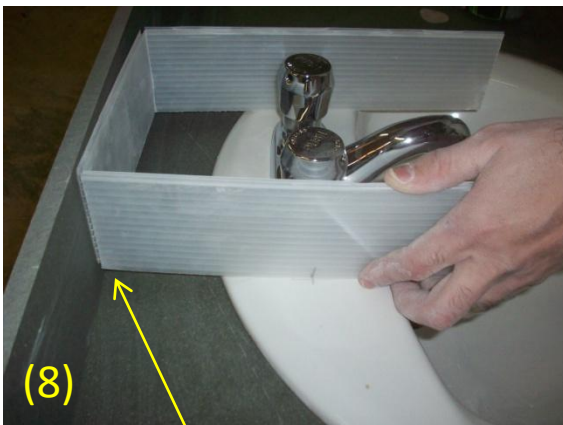

In some cases the backsplash might not have a 90 degree angle but a radius. If this is the case, cut out the radius on the template as well.

