

Installation of the Suicide Resistant Plumbing Cover



Your suicide resistant plumbing cover comes complete with no perforations. This is because not all piping configurations are installed in the same manner.

To install the cover, you will need a pair of tin-snips and a pencil to mark your cuts.



- 1) Place the cover (slope side up) over the entire plumbing tree.
- 2) Using a pencil mark the location of the piping at the base of the cover. Then mark the center of the flush handle on the side of the cover.
- 3) Start with the base and cut pipe slot using the "Jig Saw", Copping or Jack hand saw and check the alignment of the flush handle before you drill the hole. **Note: It is always smart to cut as little as possible and adjust the opening as needed.**
- 4) Before drilling the hole ensure the cover encapsulates the entire plumbing tree and check for hanging points.
- 5) Level the top of the cover before attaching to the wall to ensure it is parallel to the floor.

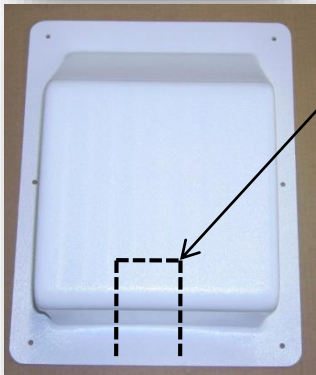
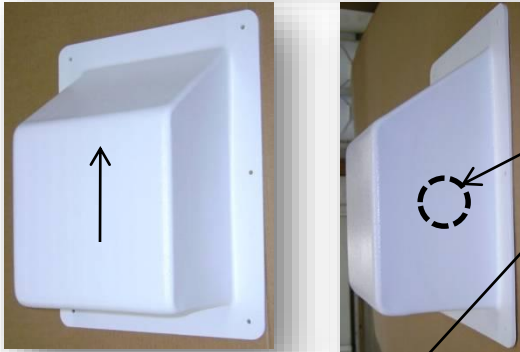

Cape Cod Systems Corporation
PO Box 276
Cohasset, MA 02025

tel 508-888-8555
fax 508-888-8140

www.capecodsystems.com
ccs@capecodsystems.com

How to measure the cover?

Please fax to:
508-888-8140
with Purchase Order

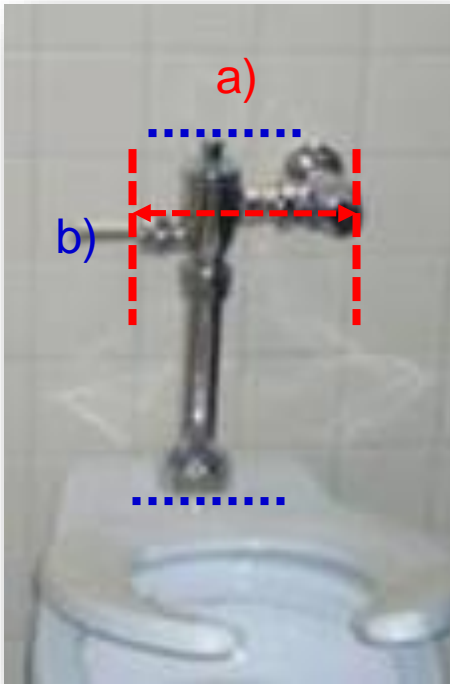

a) Width of plumbing tree?

_____ inches

b) Height of plumbing tree?
(i.e. base to top of nut)

_____ inches

c) Depth of plumbing tree?
(i.e. wall to outside of valve)

_____ inches

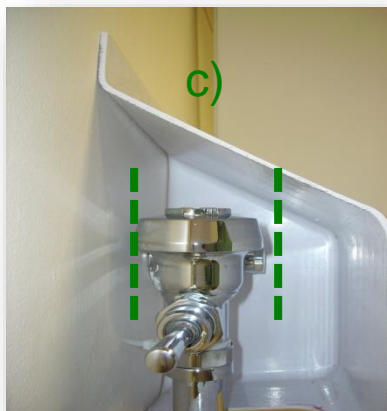

*Based on your dimensions, we will select the closest sized mold from our 100 Standard Mold Covers

Cape Cod Systems Corporation
PO Box 276
Cohasset, MA 02025

tel 508-888-8555
fax 508-888-8140

www.capecodsystems.com
ccs@capecodsystems.com

