



Combo Shower Head

LRSCOM

Anti-Ligature Combo Shower Head

Material and Construction

The shower head of the LRSCOM is made from milled chromed brass.

Operation

The shower head operates as a standard shower head with a water use of 1.5 gpm. A hose and handheld shower can be inserted into the shower head with a 1/4-turn. When the shower hose is inserted into the shower rose, water will flow through the handheld shower.

No diverter is required to divert water from the shower rose to the handheld shower.

The shower hose and handheld shower can be removed and stored in a safe location to minimize the risk of ligature.

Has a 1/2" NPT Female Water Inlet

Features

- Anti-Ligature designed hand held shower adaptor, allows easy removal of the hand shower after use.
- Durable chromed brass finish for easy cleaning and a homely look.
- Utilises an eight-turn fitting for a safe and easy attach and release.
- Is able to be adapted to existing hose and hand held showers.

Dimensions

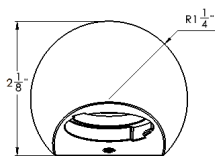
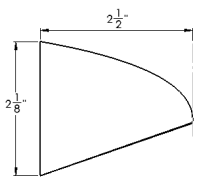

Certification



The combo shower head is certified by Intertek for compliance with ASME A112.18.1/CSA B125.1 (2018) Ed.4



Shower Head



Shower Head with Hose Attachment

Spray Pattern

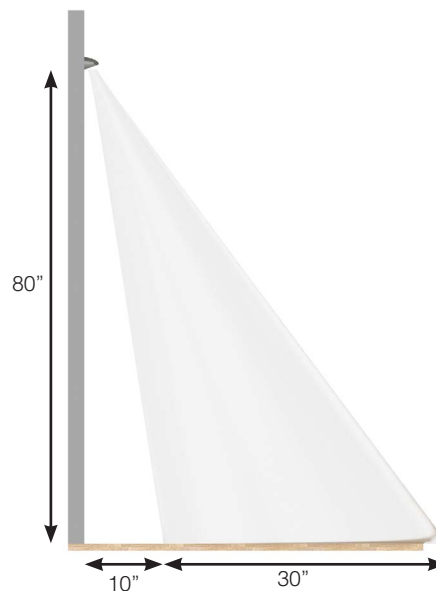

WARNING: Cancer and Reproductive Harm
www.P65Warnings.ca.gov

001 **Base Model Number** (must specify)

LRSCOM Ligature resistant Combo Shower Head