



**Whitehall Manufacturing**<sup>®</sup>  
 Manufacturer of Healthcare and Rehabilitation Products since 1946

**BestCare**<sup>®</sup>  
 Patients, Not Prisoners<sup>®</sup>

**Healthcare and Ligature  
 Resistant Products**

**Cape Cod Systems**

**888-227-8555**

**www.capecodsystems.com**

**Whitehall  
 Ligature Resistant  
 Faucet with pushbuttons  
 and Valve**

Model WH3376-WSF  
 & WH3377-WSF

Division of  
 Acorn Engineering Company<sup>®</sup>



A MEMBER OF



U.S. DESIGN PATENT D704,8065

WH3377-WSF

Fixture May Show Some Available Options

**Ligature Resistant Faucet**

**The Ligature Resistant Faucet** is designed and developed to retrofit existing lavatories or it can be specified for new design. The Ligature Resistant Faucet is arranged to be mounted to the deck of the lavatory. Faucet assembly requires (3) 1-5/16" to 1-1/2" diameter holes on 6" or 8" centerset. Conical Faucet body is chrome plated brass, includes a multi-stream, non-aerated spray nozzle insert and provides vandal and Ligature Resistance.

**Valve** is an Air-Control pneumatically operated, pushbutton valve using atmospheric air. Hemispherical pushbuttons are vandal-resistant and require less than 5 pounds of force to activate valve. Valve is metering with non-hold open feature. Metering valve timing range is 0-60 seconds. Valve can be remotely located up to 10 feet from the operating pushbutton.

**Optional -WHST70-12** Mixing Valve is ASSE 1070 compliant and delivers tempered water flow by compensating for pressure and temperature fluctuations. Valve is to be field set to 105 Fahrenheit and includes

strainers and integral checks. Operating range is 30 to 100 psi.

**Fixture is ADA Compliant.** Unit conforms with ADA requirements for accessibility when installed correctly. Compliance is subject to the interpretation and requirements of the local code authority.

**GUIDE SPECIFICATION**

Provide and install Ligature Resistant Faucet Components (specify model number and options). Faucet valve shall be Air-Control, metering, non-hold open type. Assembly shall include 0.35 GPM flow control, hot and cold hemispherical pushbuttons, pushbutton sleeve and faucet connections.

Please visit [www.whitehallmfg.com](http://www.whitehallmfg.com) for most current specifications.



Member of  
 U.S. Green  
 Building  
 Council



Recyclable  
 Product



Water  
 Conserving  
 Product

Complies  
 with the  
 following  
 standards:



Federal  
 Public Law  
 111-380  
 (No Lead)

Whitehall Mfg. • P.O. Box 3527 • City of Industry, CA 91744 • (800) 782-7706 • (626) 968-6681 • Fax (626) 855-4862

**WH3376-WSF**

NEW: 02/15/19



**Cape Cod Systems**

888-227-8555

[www.capecodsystems.com](http://www.capecodsystems.com)

**MODEL NUMBER AND OPTIONS SELECTION:**

**BASE MODEL NUMBER**

- WH3376-WSF Ligature Resistant Faucet with Air-Control Valve Assembly, Single Temp
- WH3377-WSF Ligature Resistant Faucet with Air-Control Valve Assembly, Hot & Cold

**OPTIONS:**

- WHST70-12 ASSE 1070 Compliant Hot & Cold, Temperature / Pressure Balancing Mixing Valve

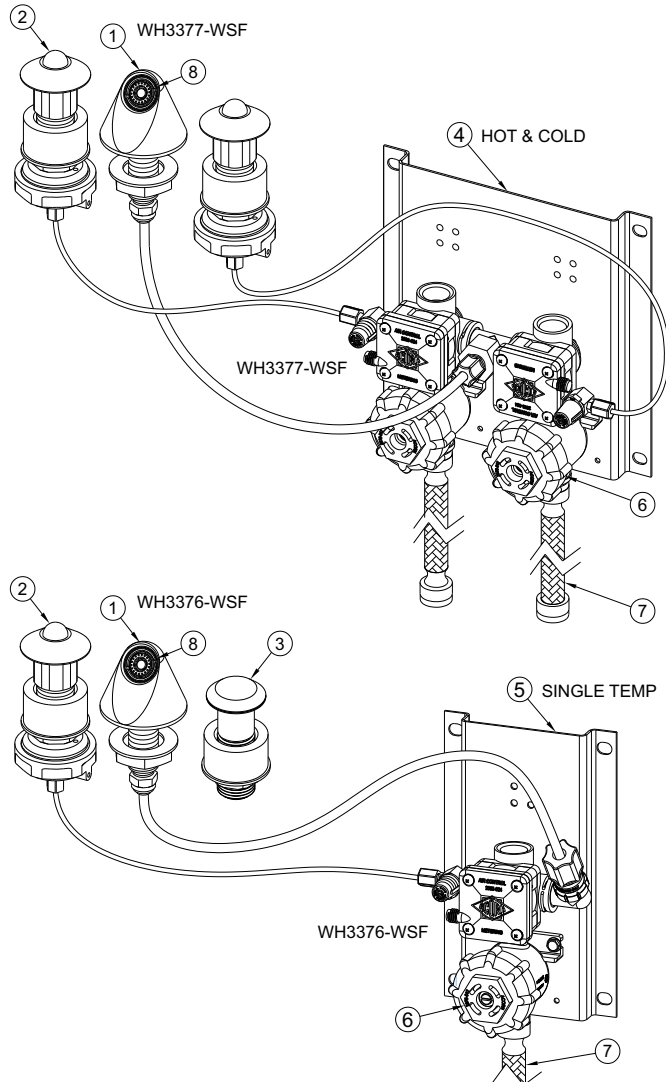
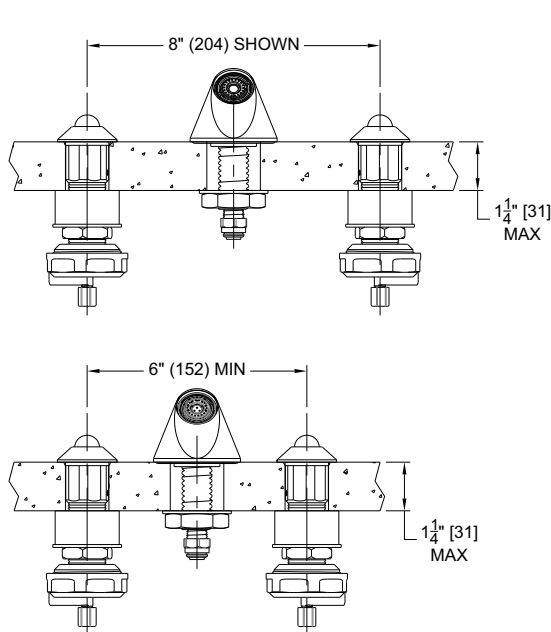

**NOTES:**

1. CONICAL LIGATURE RESISTANT SPOUT
2. LIGATURE RESISTANT PUSHBUTTONS
3. BLANK PUSHBUTTON ESCUTCHEON, SINGLE TEMPERATURE ONLY
4. AIR CONTROL VALVE ASSEMBLY, TEMPERED AND COLD
5. AIR CONTROL VALVE ASSEMBLY, SINGLE TEMPERATURE
6. CHECKSTOP/STRAINER ASSEMBLY
7. 1/2" NPS INLET FLEX HOSE
8. MULTI-STREAM, NON-AERATED NOZZLE INSERT

**DISCLAIMER:**

This product is designed to decrease the probability that it may be utilized as an apparatus for ligature. It is not a replacement for professionals who are trained in the proper evaluation, management and supervision of persons at risk of suicide.

**WARNING:** Cancer and Reproductive Harm - [www.P65Warnings.ca.gov](http://www.P65Warnings.ca.gov)

**SELECTION SUMMARY & APPROVAL FOR MANUFACTURING**

Model Number & Options \_\_\_\_\_ Quantity \_\_\_\_\_  
 Company \_\_\_\_\_ Date \_\_\_\_\_  
 Contact \_\_\_\_\_ Title \_\_\_\_\_  
 Approval for Manufacturing/Signature \_\_\_\_\_

All dimensions are nominal and subject to manufacturer's change without notice. Whitehall assumes no responsibility for use of void or superseded data. Whitehall Manufacturing, Member of Morris Group International. Please visit [www.whitehallmfg.com](http://www.whitehallmfg.com) for most current specifications.