



DRINKING FOUNTAIN

A151-VR Series

BARRIER FREE, VANDAL RESISTANT,
WALL MOUNTED DRINKING FOUNTAIN

STANDARD FEATURES

- Child or Adult ADA Compliant (when properly installed)
- 18 gage, 304 Stainless Steel Basin and Flush Mounted Chrome Plated Brass Button
- Polished Stainless Steel, Anti-Rotation, Non-Squirt Bubbler
- 100-Mesh Inlet Strainer
- Vandal Resistant Screws
- Integral P-trap
- Mounting Plate with Hardware

SUGGESTED SPECIFICATIONS

Model A151400S-VR is a Vandal Resistant Wall Mounted Drinking Fountain made from 18 gage, 304 stainless steel with a brushed finish. Unit shall be activated by Chrome Plated Brass Pushbutton using less than 5 pounds of force. Bubbler shall be polished stainless steel with a non-squirt feature and operate on a water pressure range of 20-105 PSIG. Unit shall have a uniquely designed, two-piece contoured Bowl with P-trap integral to the unit. Unit is certified to ANSI A117.1, Public Law 111-380 (NO-LEAD), CHSC 116875 and NSF/ANSI 61, Section 9. Fixture meets ADA, ADA Standing Person, and ADA Child requirements when mounted appropriately.



MODEL:

(Must Specify)

FLEXIBLE BUBBLER (0.3 GPM)

- ☐ A151200F-VR Bronze finish
- ☐ A151300F-VR Gold finish (High Polish)
- ☐ A151400F-VR Satin stainless finish

LEAD-FREE STAINLESS STEEL BUBBLER

- ☐ A151200S-VR Bronze finish
- ☐ A151300S-VR Gold finish (High Polish)
- ☐ A151400S-VR Satin stainless finish (Shown)

OPTIONS

(additional costs may be incurred)

- ☐ -AD1 Access door
- ☐ -AP1 Access panel for a single fountain
- ☐ -BP2 Back panel for single contoured fountain
- ☐ -CSC Concealed support carrier
- ☐ -FRA1 Freeze resistant valve
- ☐ -HP High polished stainless steel
- ☐ -MF1 Mounting frame for a single fountain
- ☐ -SO Sensor Operated
- ☐ A9100080-A 8 GPH remote water chiller
(Recommended to be with 10 Feet of Fixture)

Complies
with the
following
standards:



Member of
U.S. Green
Building
Council



Recyclable
Product



Water
Conserving
Product



DRINKING FOUNTAIN

A151-VR Series

BARRIER FREE, VANDAL RESISTANT,
WALL MOUNTED DRINKING FOUNTAIN

CAPE COD SYSTEMS CORPORATION

TEL. 1-888-227-8555

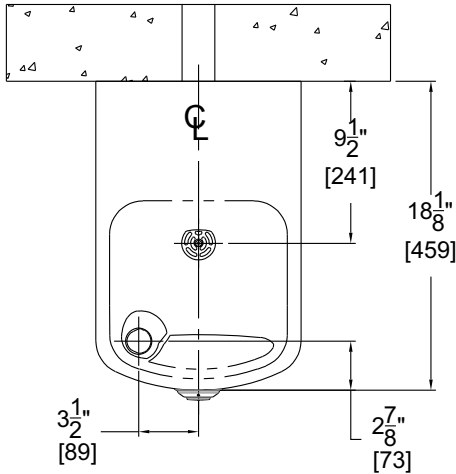

GENERAL NOTES:

1. ALL DIMENSIONS ARE IN INCHES [MM].
- *2. DIMENSIONS SHOWN ARE FOR RECOMMENDED HEIGHT. ADJUST VERTICAL DIMENSIONS AS NECESSARY TO COMPLY WITH FEDERAL, STATE, & LOCAL CODES.
3. STOP VALVE NOT PROVIDED.

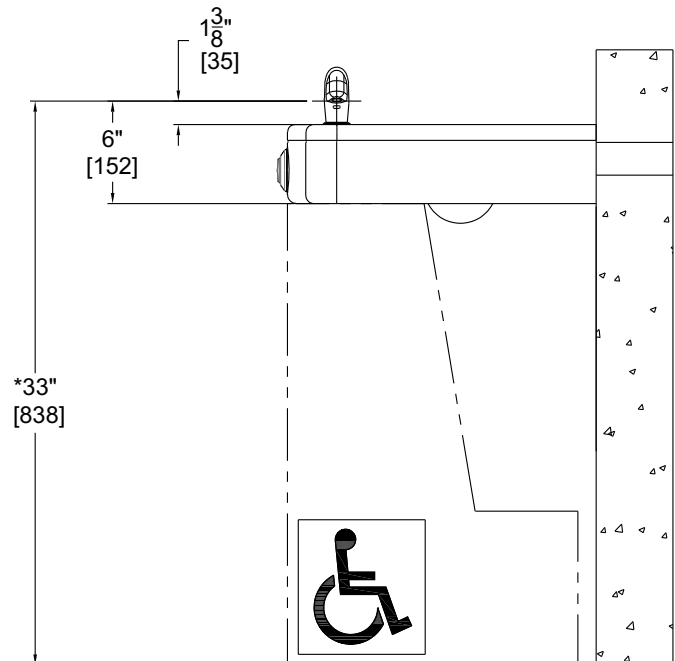
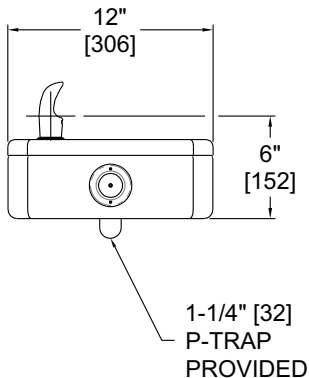

Murdock Mfg.™ warrants that its products are free from defects in material or workmanship under normal use and service for a period of one year from date of shipment. Murdock's liability under this warranty shall be discharged solely by replacement or repair of defective material, provided Murdock™ is notified in writing within one year from date of shipment, F.O.B. Industry, California.

SELECTION SUMMARY
& APPROVAL FOR
MANUFACTURING

Model Number & Options _____ Quantity _____

Company _____

Contact _____ Title _____

Signature (Approval for Manufacturing) _____ Date _____

All dimensions are subject to manufactures tolerance of plus or minus 1/8" nominal and subject to change without notice. Murdock assumes no responsibility for use of void or superseded data. Dimensions may change with the addition of optional accessories. Murdock Mfg.™, Member of Morris Group International™. Please visit www.murdockmfg.com for most current specifications.